

ND-100 GPS Dongle Quick Start Guide

Version 0.3



Accessories



ND-100 Unit

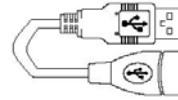

USB cable



CD (user manual, driver, applications, and map data)



Quick Guide

Note:

1. If any item is missing or damaged, please contact with your local retailer.

Overview

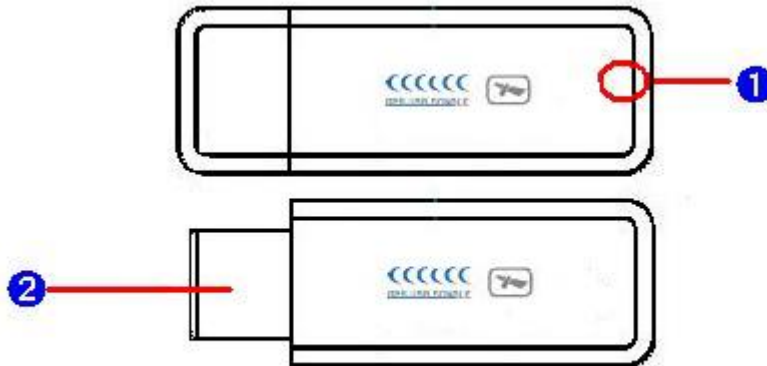

Front View	
Status LED(Blue)	Blinking – GPS position is fixed Steady light – GPS position is not fixed
USB CONNECTOR	TO Connect Laptop USB PORT

How to start

1. Connect the ND-100 to laptop USB PORT.
2. To choose and install the ND-100 driver in the CD, so that we can identify the Laptop ND-100.
3. Wait for the completion of the ND-100 satellite positioning, the ND-100 location indicator light (blue light) will blink
4. ND-100 will be the time for the positioning of various environmental and climate variables, ND-100 has not received satellite positioning and poor, you can use the attached USB product line extension of the (15cm) in order to Stretch performance

Connect to Laptop or UMPC

Connect to notebook

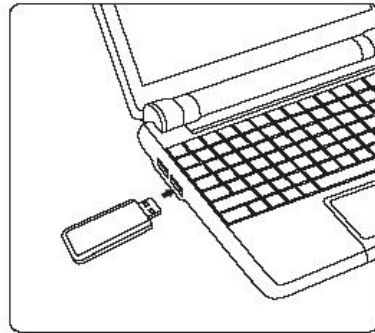
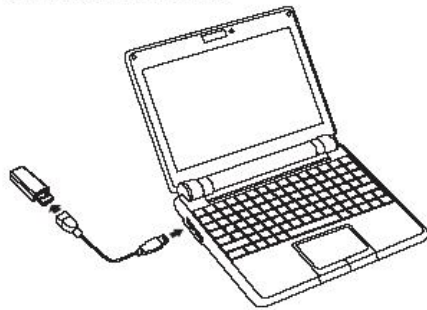

Connect to UMPC

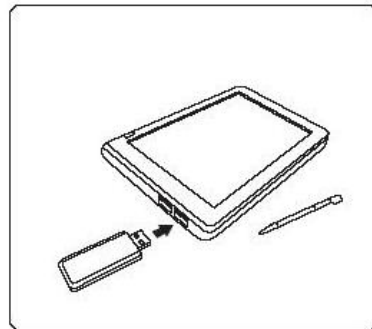
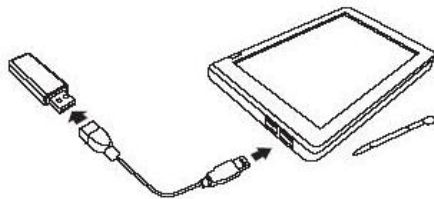

USING / TESTING ND-100

Once the ND-100 receiver's driver and your personal mapping software have been installed and configured properly, you can begin to use your navigation system by plugging the ND-100 into your laptop's USB port and launching your mapping software. If you don't have a mapping, or navigation software, we've included a GPS test utility called "MiniCDU" for the purpose of confirming your installation and configuration. This utility can be installed by clicking the [MiniCDU.exe](#) file from the Win directory on the CD-ROM or downloaded from our web-site www.globalsat.co.uk

LED Status indicator on the ND-100

LED OFF: GPS receiver is off (no power).

LED ON (solid): No fix, searching for GPS signals.

LED FLASHING: Position fix established and GPS signals are being received.

Always select an area in the vehicle where the GPS unit will be secure and not obstruct normal driving, visibility and safety, but still maintaining a "view to the sky" in order to receive satellite data.

It is recommended that you first load and test your GPS receiver with the MiniCDU.exe. This process will confirm you have found correct COM port number and have configured it properly.

1. Run [MiniCDU.exe](#) to load the utility.
2. Enter the proper COM port for your GPS device (see COM Port Verification above)
3. Set COM port to Baud rate: 38400
4. If no errors have been made in configuration, there should be GPS data being displayed in the window, which is confirmation that the communication between the GPS device and the "MiniCDU" software is working properly.

